

# OVERLAY FOR THE WATERMARK, TEMPE SITE PLAN

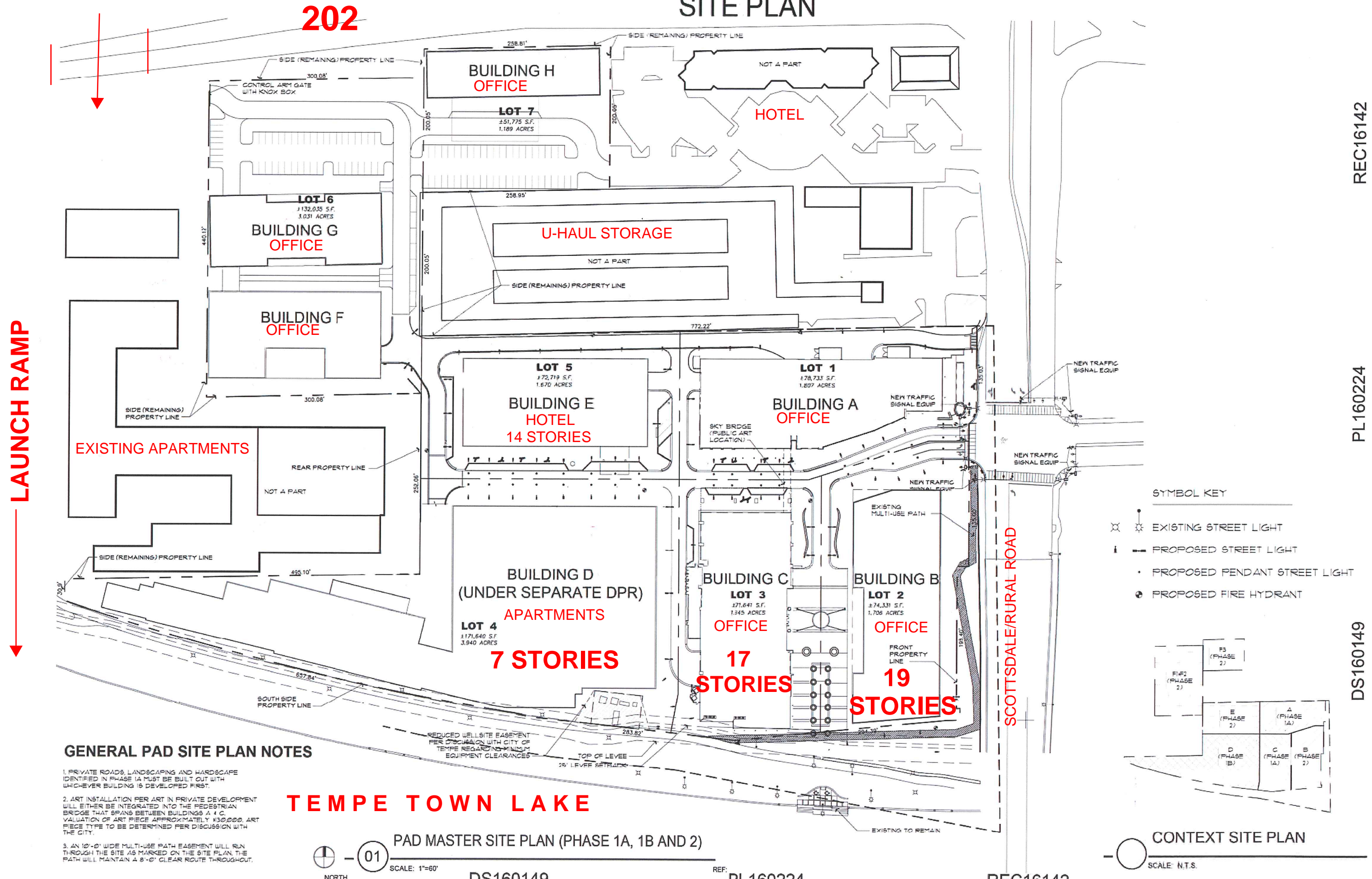

ARCHITECTS &  
Nelsen Partners, Inc.  
Austin | Scottsdale  
15210 North Scottsdale  
Suite #300  
Scottsdale, Arizona 85254  
t: 480.949.6800  
nelsonpartners.com

REGISTERED ARCHITECT  
28515 GEORGE A. MELARA  
SCOTTSDALE, ARIZONA U.S.A.  
Expires 12-31-2024

REC16142  
PL160224  
DS160149

**THE WATERMARK | TEMPE**  
Fenix Development

Date  
DECEMBER 21, 2024

Drawings and written matter herein constitute original and confidential work of the architect and shall not be reproduced, copied, or disclosed without the consent of the architect.  
© 2014 NELSEN PARTNERS  
Project No.  
315029  
A102  
PAD MASTER SITE PLAN  
(Phase 1A, 1B, & 2)